

711 Edison

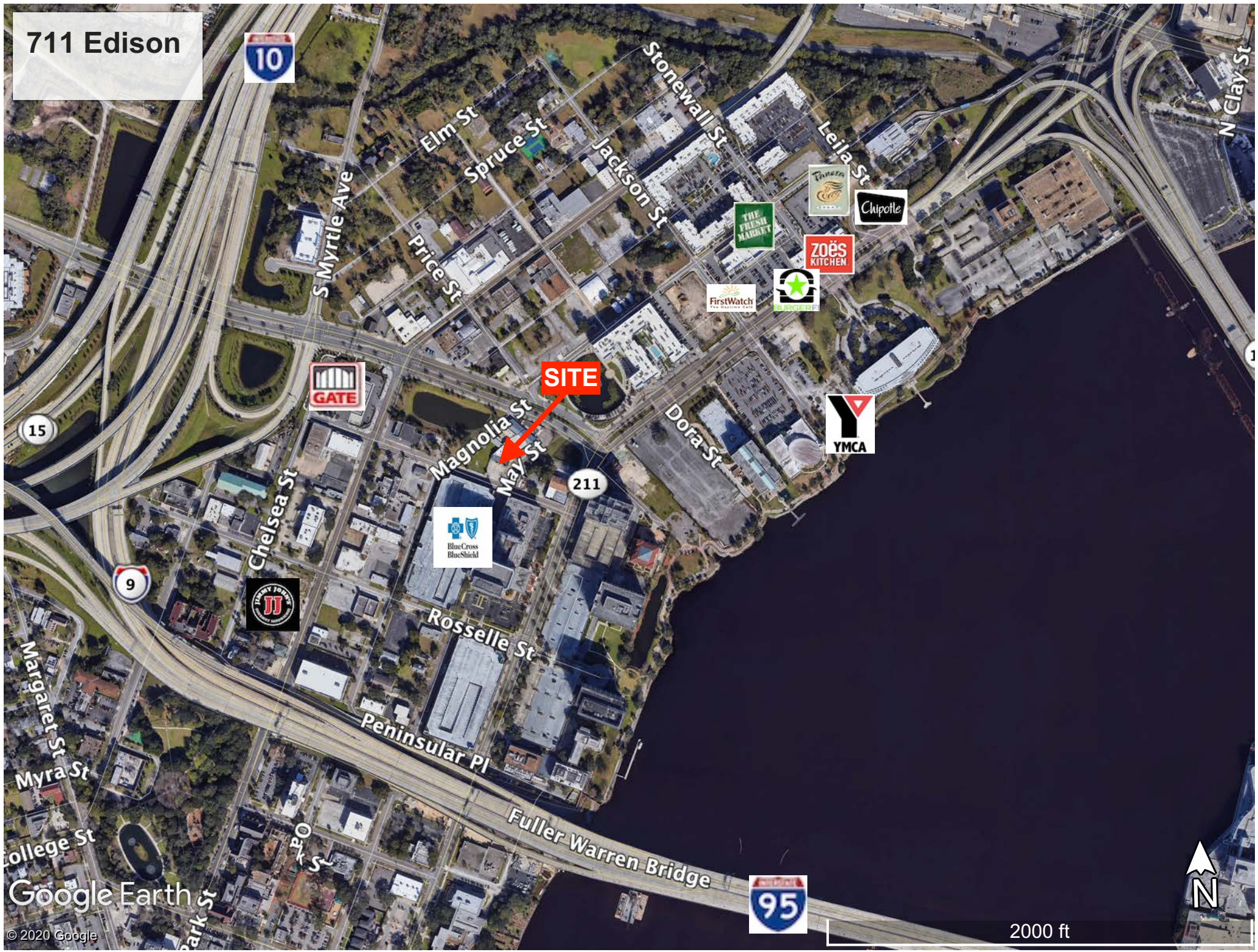

15



SITE

211

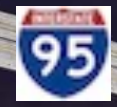

2000 ft

Location Map



Demographics	1 Mile	3 Mile	5 Mile
2020 Total Population:	5,459	88,347	194,828
2025 Population:	5,838	93,769	206,105
Pop Growth 2020-2025:	6.94%	6.14%	5.79%
Average Age:	43.90	38.90	38.70
2020 Total Households:	3,232	36,972	80,763
HH Growth 2020-2025:	7.27%	6.29%	5.79%
Median Household Inc:	\$46,953	\$38,897	\$38,825
Employees:	37,133	122,206	181,862

Space Plan – 711 Edison Avenue

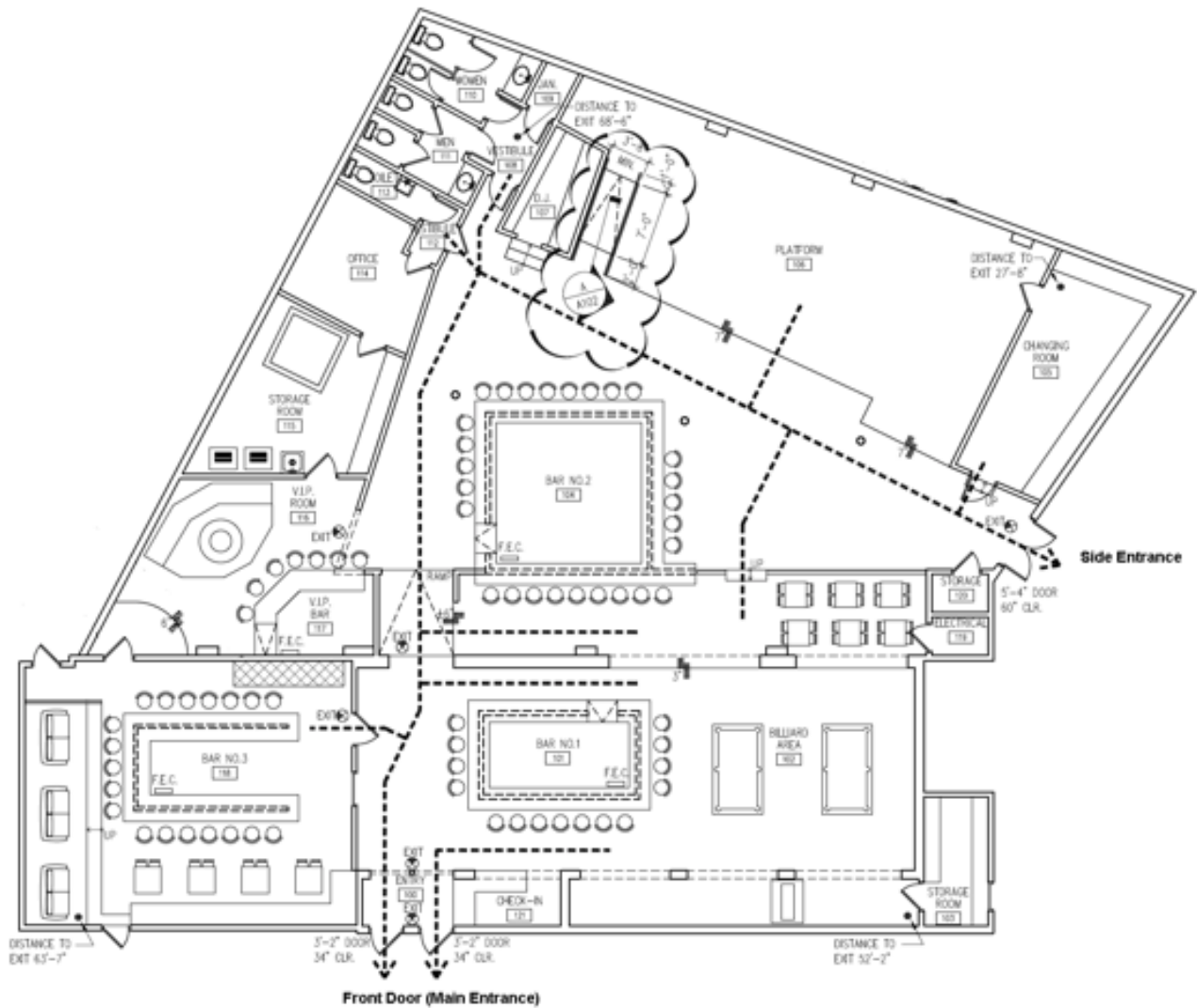

Survey – 711 Edison Avenue

